

INF No. A-5 Original
 History of original corner establishment:

This corner was originally established by Bamford Robb and Herman D. Gradon, in 1881 under GLO Contract Number 383. Surveyor General Field Notes state:

Intersect Standard line at a point 5.75 chs East of Standard Corner to Sec's 31 & 32 which is a stone 12x10x8 in stone mound from which a Pine 16 in. dia., bears N15°E, 4 lks. dist.
 Pine 18 in. dia., bears N70°E, 2 lks. dist.

At point of intersection I set a basalt stone 16x10x6 for closing corner to Sec's 5 & 6 from which
 A Pine 24 in. dia. bears S30°E, 78 lks. dist.
 A Pine 26 in. dia. bears S40°W, 57 lks. dist.

In 1895, W.F. White, County Surveyor, states he re-established this corner as recorded in Grant County Surveyor Records: Book B, Page 7. His record states:

"Established corners to Secs 5 and 6 on North boundary of Township 11 South Range 35 East being 2nd Oregon Parallel South Commenced at NE corner of Township and run West on true course Var. 20°30'E

40.00 1/4 cor in good condition

80.00 No Section corner bearing trees remaining as indicated in U.S. Field Notes, I placed stone 10x11x12 in stone mound.

Done in presence of David Cautwell and Clarence Glasgow Sept 12th 1895"

Recorded Feby 21th 1896

Description of Corner Evidence Found:

Found a 12"x12"x7" stone in center of a mound of stone. No marks visible on the stone.

Found a badly weathered Ponderosa Pine stump, with scribing visible, bears S48°46'W, 31.0 ft. (Rec: S40°W, 37.62 ft).

After a long evaluation I decided to accept this stone in the mound of stone as Robb and Gradon's corner. While it's position when compared to the record is less than desirable, I have found in several other instances a problem with Robb and Gradon's record and the physical evidence on the ground.

The original record for T.11S., R.35E., W.M. has no indication of the establishment of the north 1/4 corners for Sections 1-6, nor was any evidence found in the field. Yet Mr. White's record indicates he resurveyed the north boundary of T.11S., R.35E., and recovered a 1/4 corner and then re-established the section corner for Sections 5 and 6 after not recovering any of the original bearing trees. I find no evidence of Mr. White's survey.

Description of monument and accessories I established to perpetuate the original location of this corner:

Set 2-1/2"x30" aluminum pipe with 3-1/4" aluminum cap, stamped as shown on the DIAGRAM, 28" in the ground and placed the original stone alongside the north side of the monument. No bearing trees were taken to this monument. The monument I placed on the Second Standard Parallel South bears, N00°04'35"W, 3.20 ft.

DIAGRAM

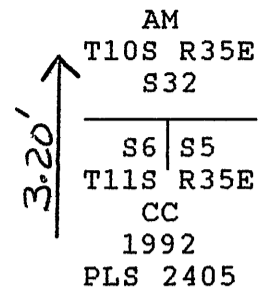

REGISTERED
 PROFESSIONAL
 LAND SURVEYOR

Susan E. Newstetter

OREGON
 JULY 26, 1989
 SUSAN E. NEWSTETTER
 OFFICER OF

This work was performed by:
 Susan E. Newstetter PLS 2405
 Witnessed by: D. Mitchell Ferguson
 and Rick Saul
 November 2, 1992
 Refer to Grant Co. Survey No.: 1239

State of OR I hereby certify that the within instrument was
 filed in this office for record on the 20 day of Jan., 1993
 by _____ (COUNTY OFFICIAL) _____ (DEPUTY)

EXP
 12/31/94

A-5 AM